

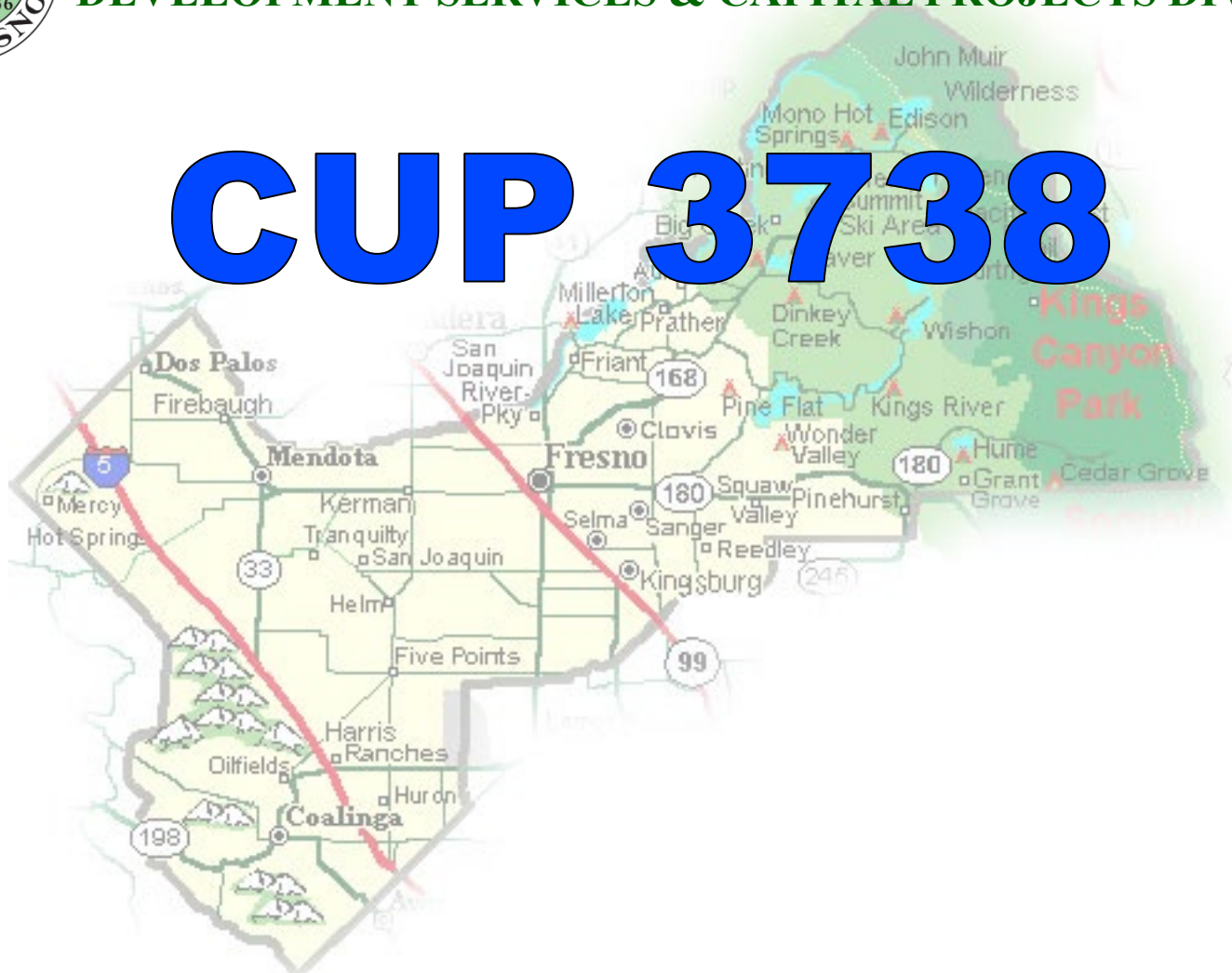

DEPARTMENT of PUBLIC WORKS and PLANNING DEVELOPMENT SERVICES & CAPITAL PROJECTS DIVISION

CUP 3738



LOCATION MAP

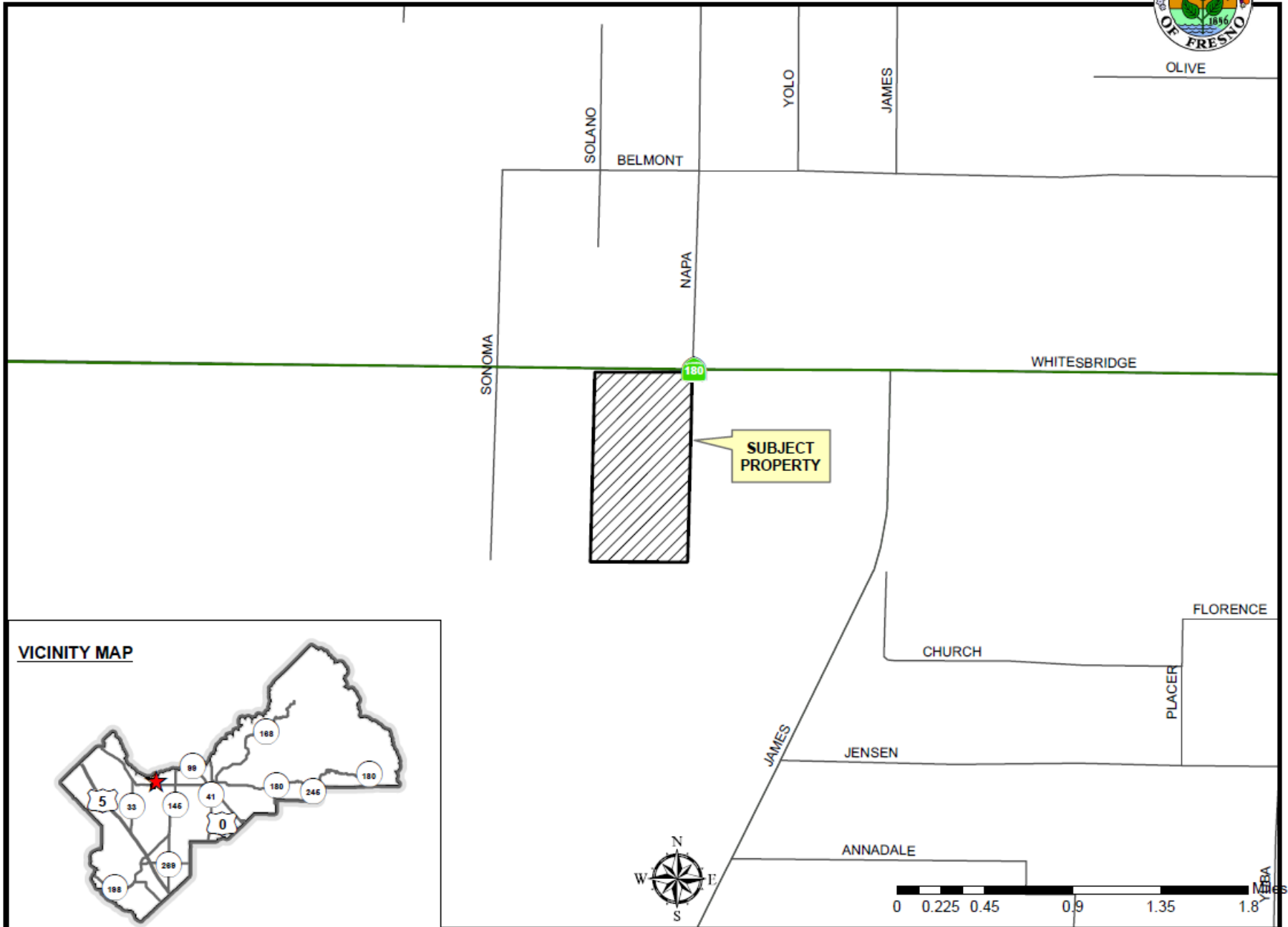

VICINITY MAP

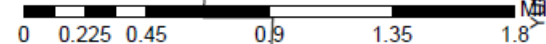
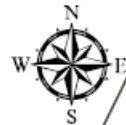
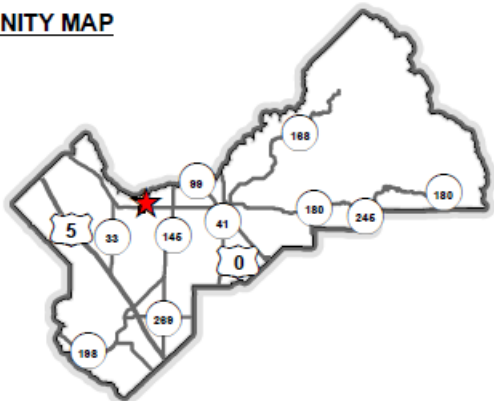

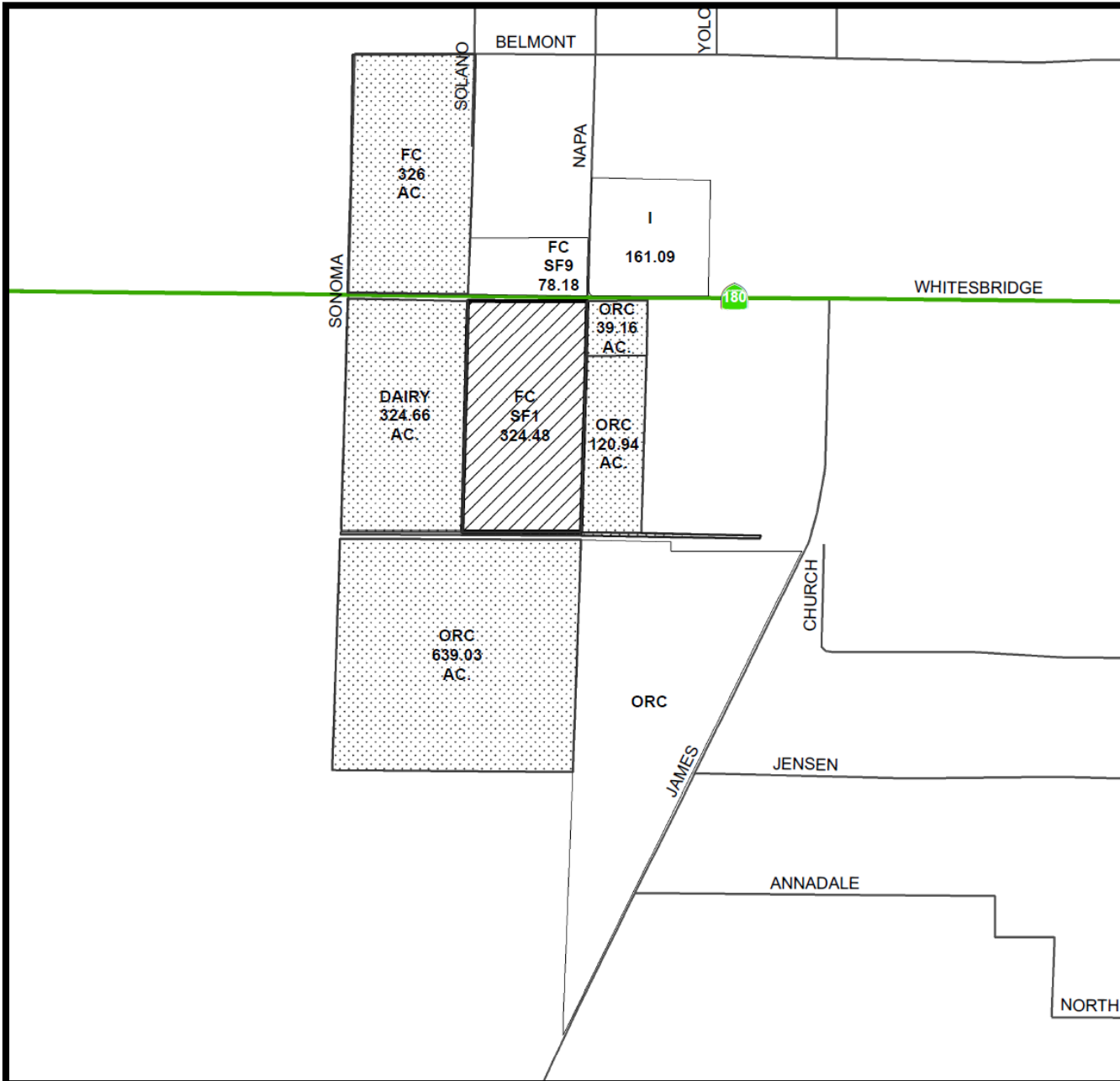

EXISTING LAND USE MAP



LEGEND	
V - VACANT	
DAIRY	
FC - FIELD CROP	
I - INDUSTRIAL	
ORC - ORCHARD	
SF# - SINGLE FAMILY RESIDENCE	

LEGEND:

-  Subject Property
-  Ag Contract Land



Department of Public Works and Planning
Development Services Division

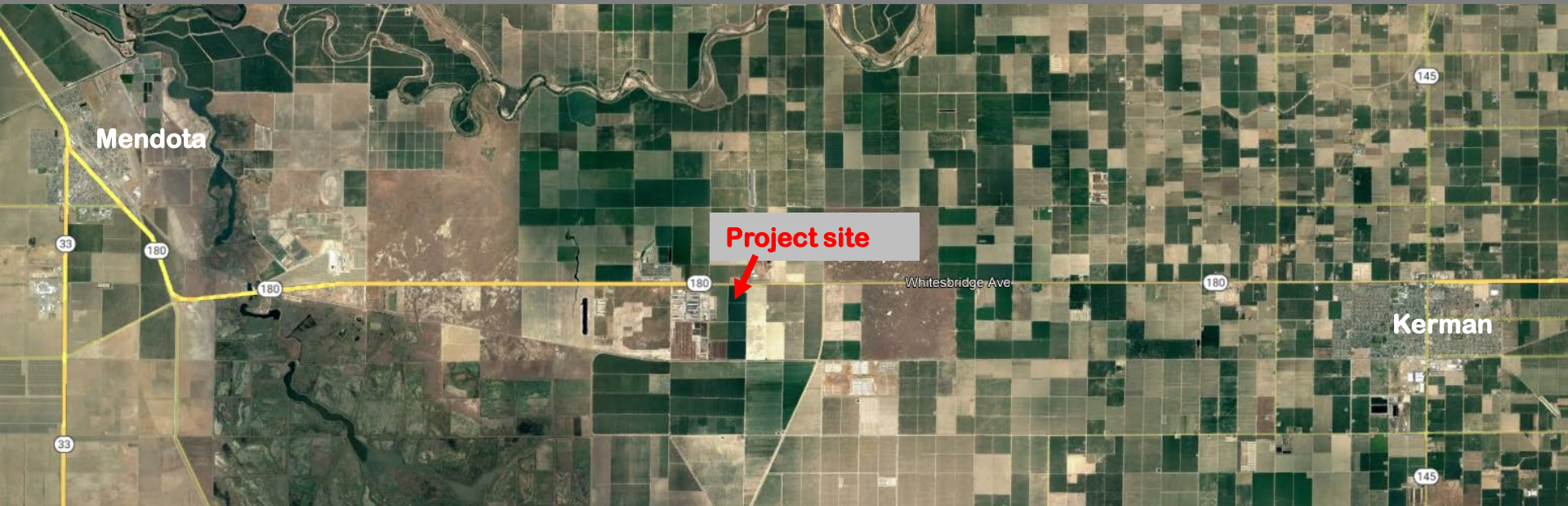

Mendota

Project site

Whitesbridge Ave

Kerman

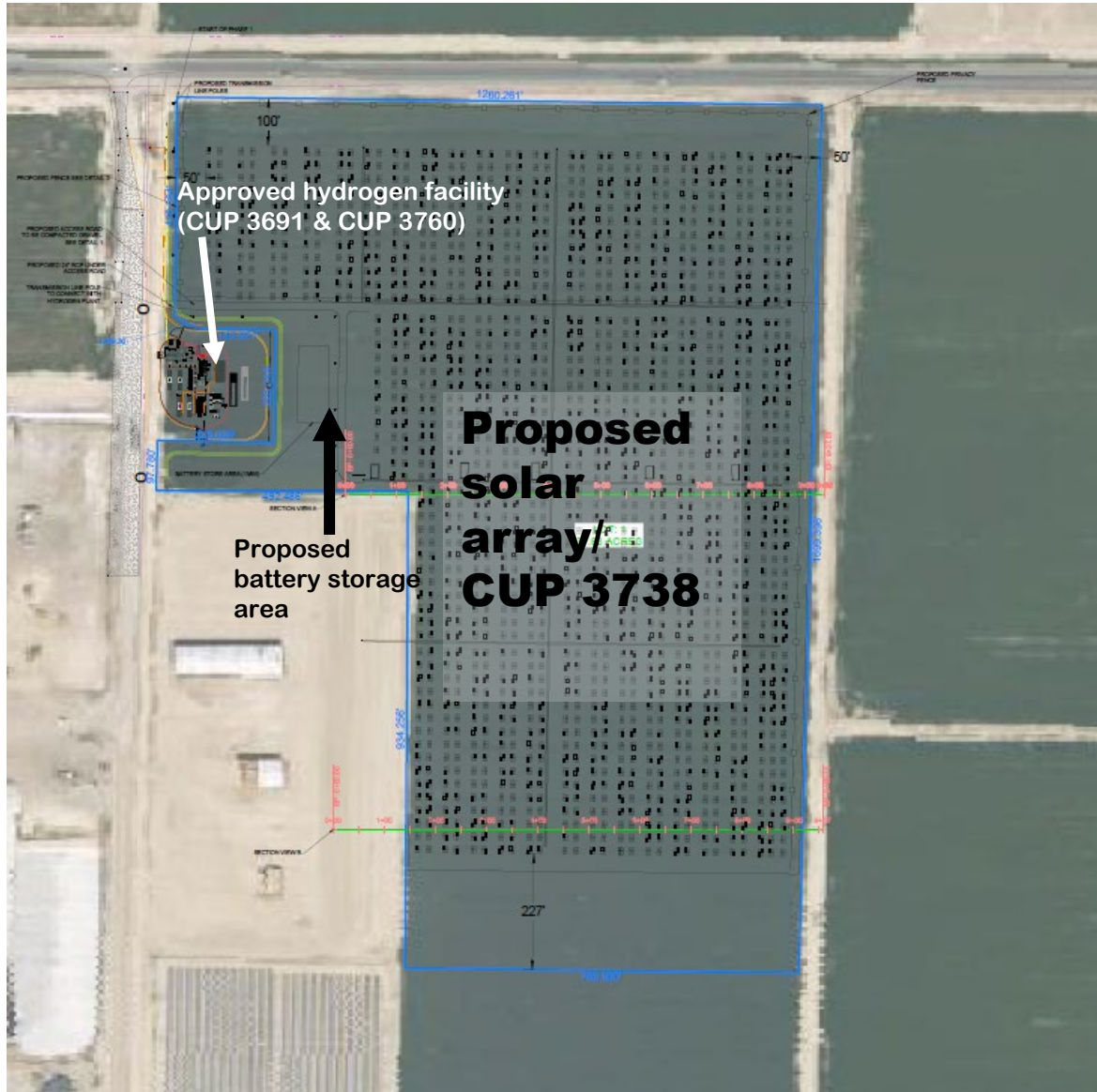

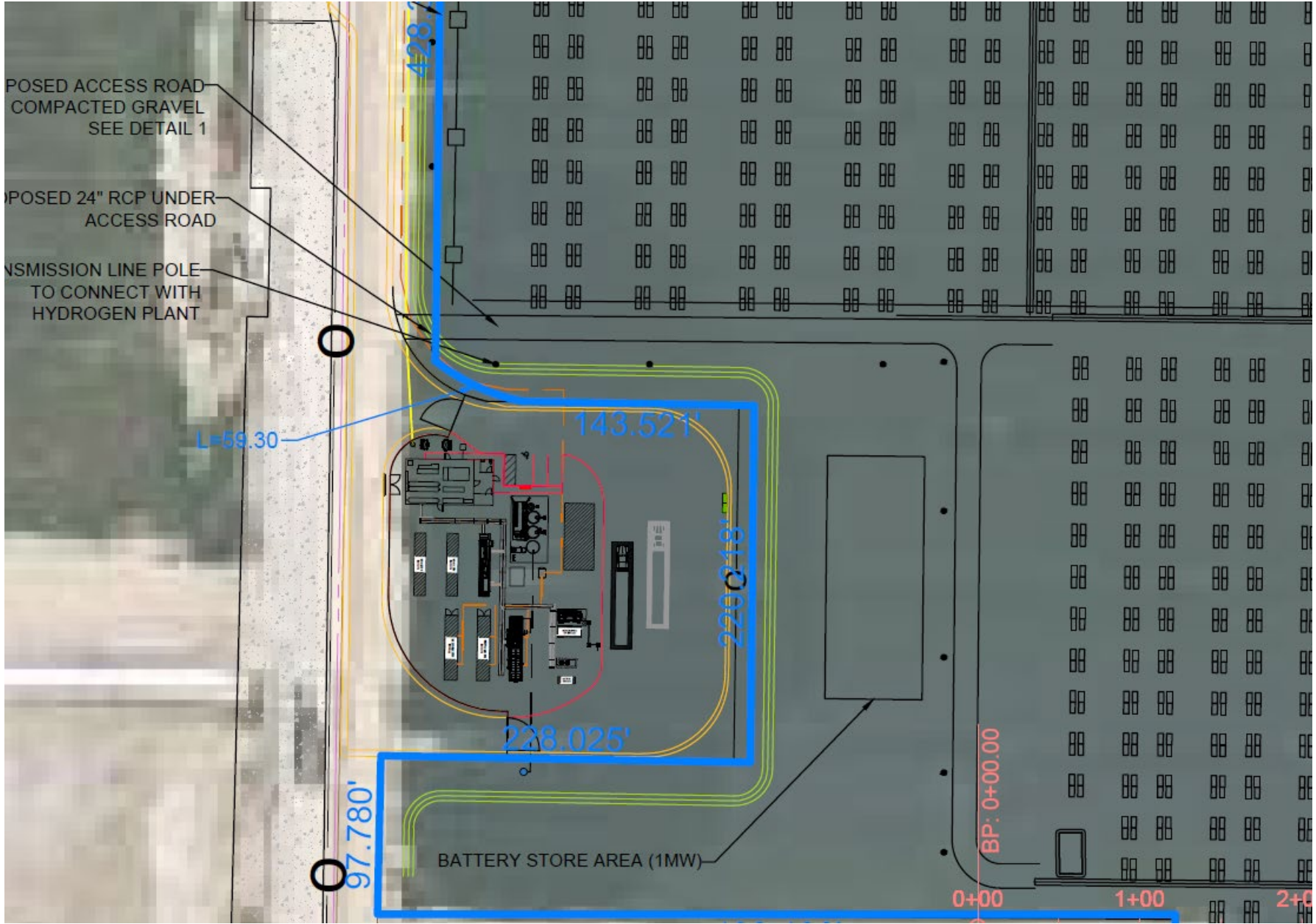

Findings	Description	Findings Met
1	Size and shape of parcel is adequate.	YES
2	Streets and highways are adequate for use.	YES
3	No adverse effect on neighborhood.	YES
4	General Plan consistency.	YES
5	Conditions necessary for public health, safety, and general welfare.	YES



DEPARTMENT of PUBLIC WORKS and PLANNING
DEVELOPMENT SERVICES & CAPITAL PROJECTS DIVISION

CUP 3738





EXISTING ZONING MAP

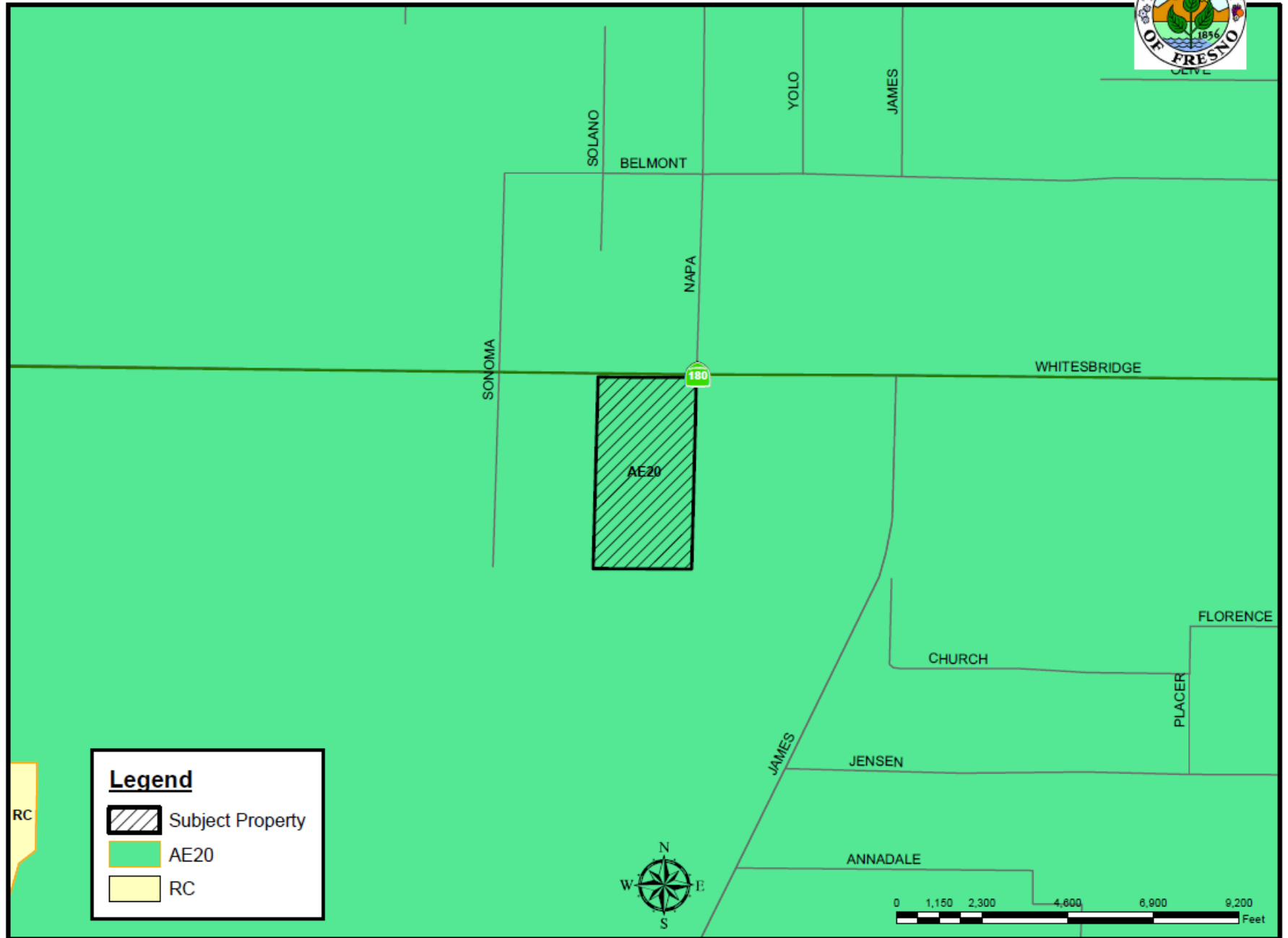

Legend

- Subject Property
- AE20
- RC