

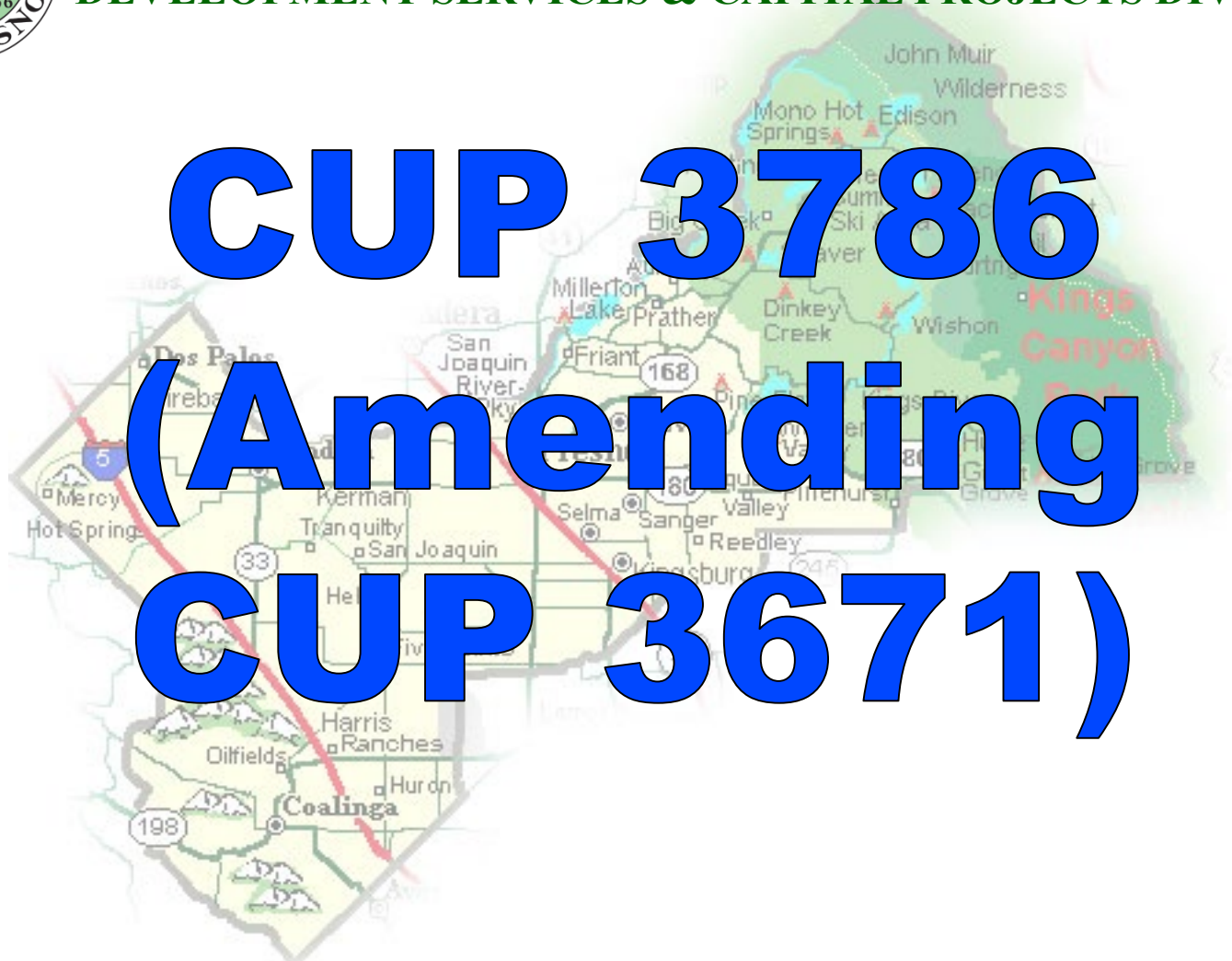

DEPARTMENT of PUBLIC WORKS and PLANNING
DEVELOPMENT SERVICES & CAPITAL PROJECTS DIVISION

CUP 3786
(Amending
CUP 3671)

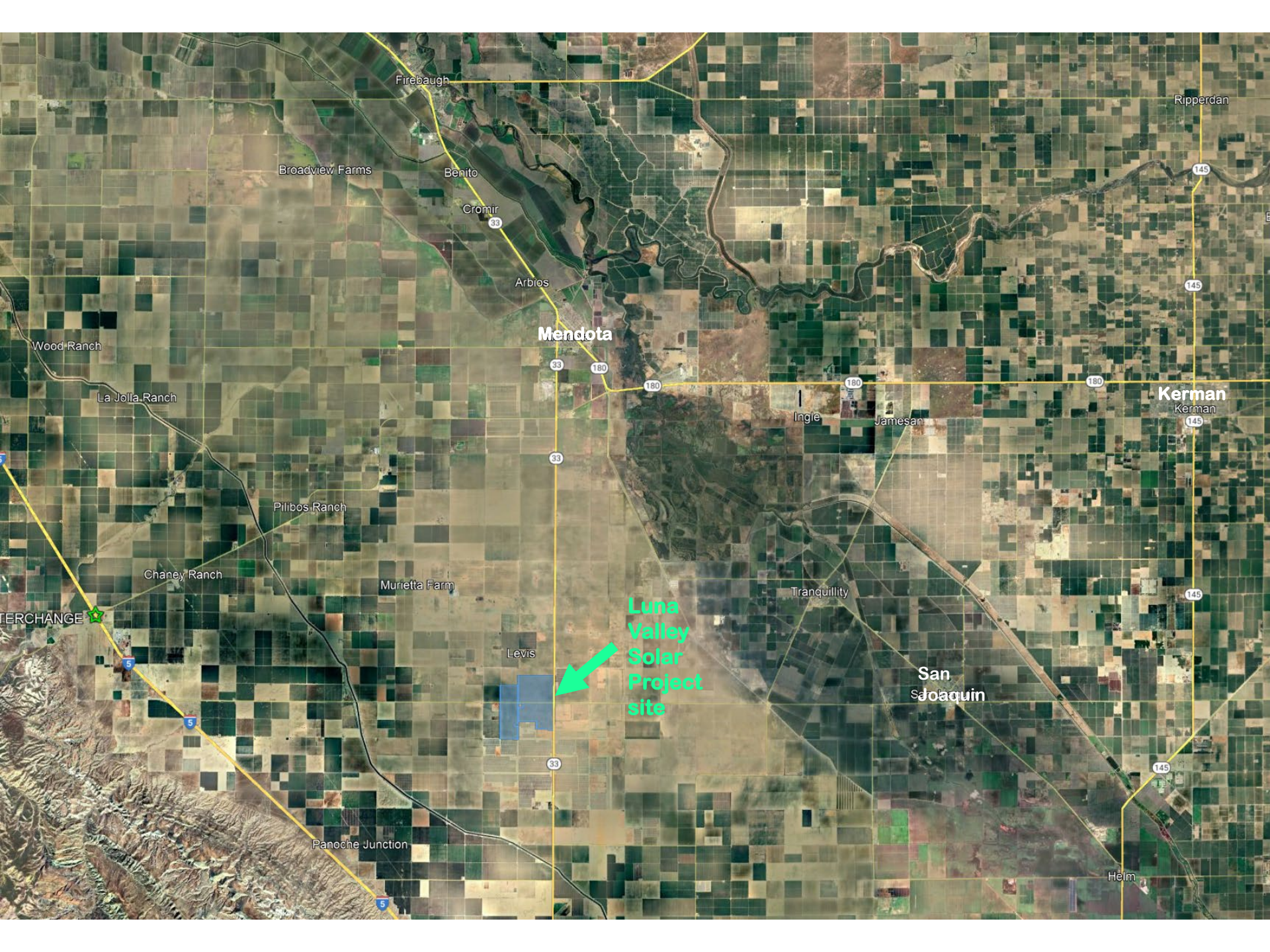



Mendota

Kerman

Luna Valley Solar Project site

San Joaquin

Firebaugh

Broadview Farms

Benito

Cromir

Arblos

Wood Ranch

La Jolla Ranch

Pilibos Ranch

Chaney Ranch

Murietta Farm

Levis

Tranquility

Ingle

Jamesan

Ripperdan

Kerman

Helm

Panoche Junction

Legend



Subject Properties

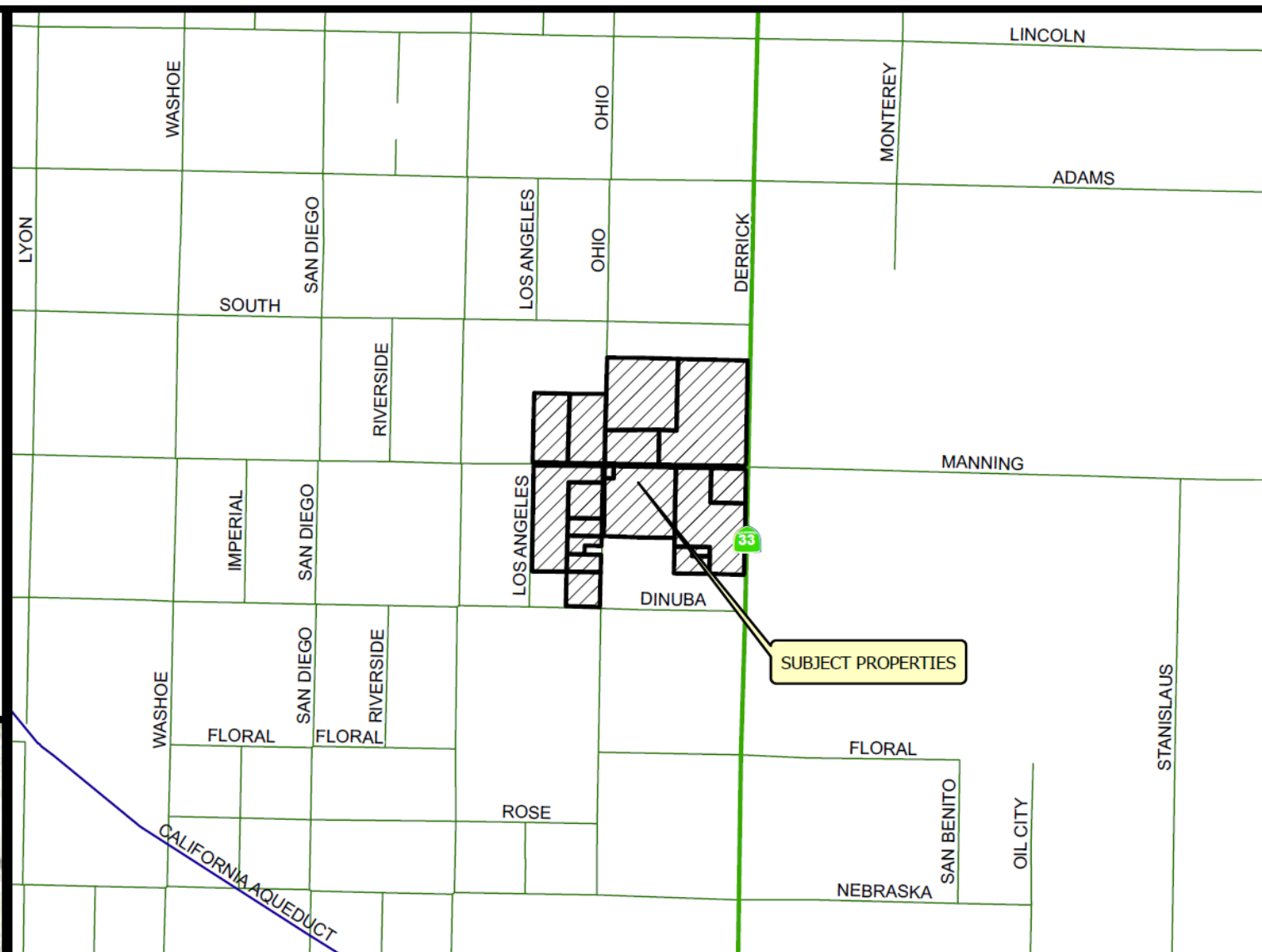

VICINITY MAP

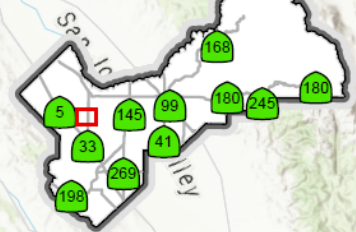

LOCATION MAP

CUP 3786

2024

Prepared by : County of Fresno, Department of Public Works and Planning, Development Services Division
Person Prepared by : chuang
On Date : 3/7/2024

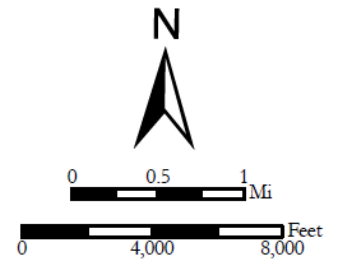

Proposed modified mitigation measure

Approved Mitigation Measure 4.18-1

Applicant shall enter into a secured agreement with Fresno County to ensure that any County roads that are demonstrably damaged by Project-related activities are promptly repaired and, if necessary, paved, slurry-sealed, or reconstructed as per requirements of the state and/or Fresno County.

Proposed Modified Mitigation Measure 4.18-1

Prior to final inspection of building permits, release of any temporary power deposits, or the start of operations other than testing process of the facilities the Applicant shall crack seal & chip seal Manning Ave between Derrick Avenue and the Ohio Avenue Alignment. The full width of all construction entrances shall be grinded to a depth of .30 foot and replaced with hot mixed asphalt for the full width of the roadway prior to the chip seal application.

Findings	Description	Findings Met
1	Size and shape of parcel is adequate.	YES
2	Streets and highways are adequate for use.	YES
3	No adverse effect on neighborhood.	YES
4	General Plan consistency.	YES
5	Conditions necessary for public health, safety, and general welfare.	YES



DEPARTMENT of PUBLIC WORKS and PLANNING
DEVELOPMENT SERVICES & CAPITAL PROJECTS DIVISION

CUP 3786
(Amending
CUP 3671)

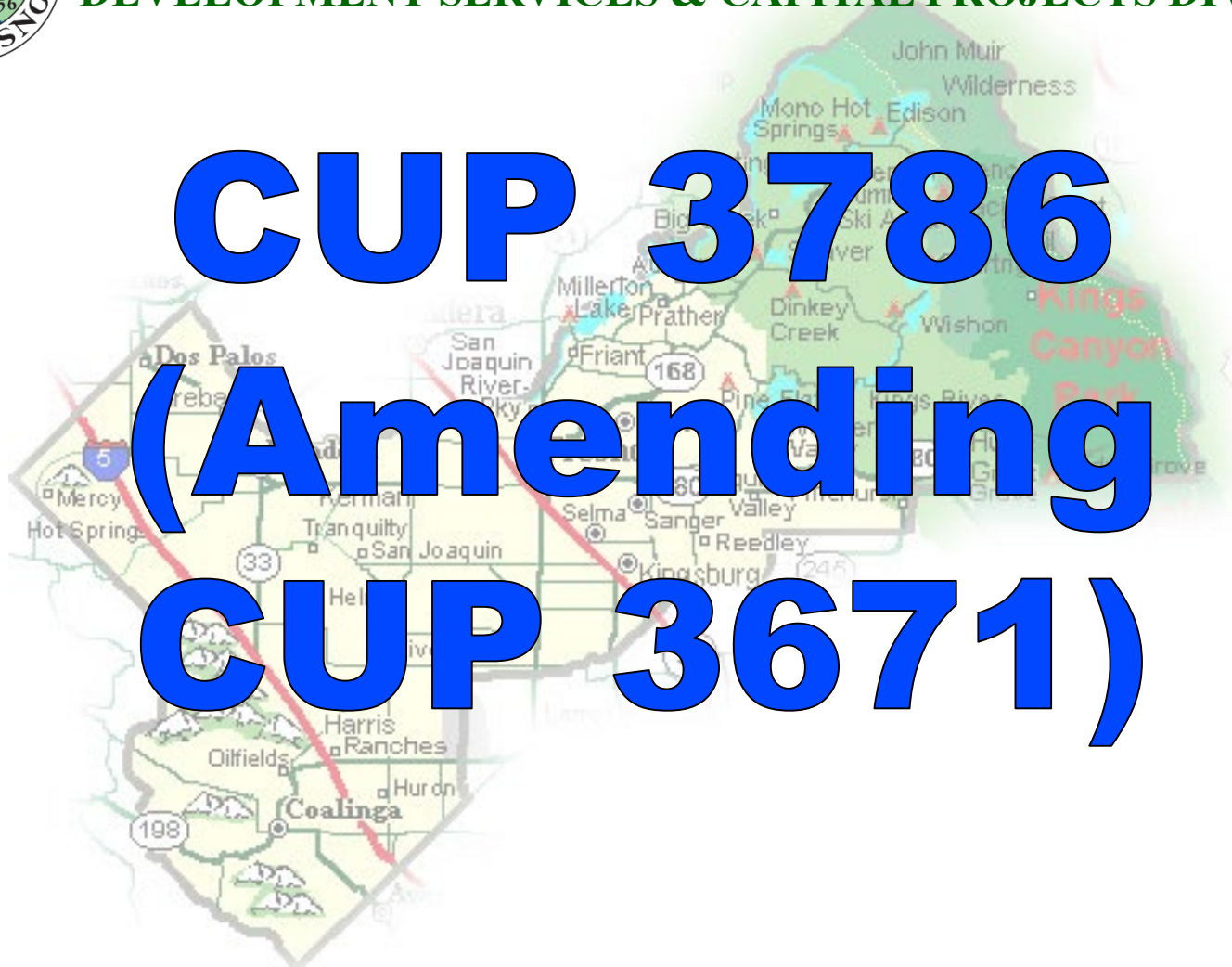

Legend



Subject Properties



AE20

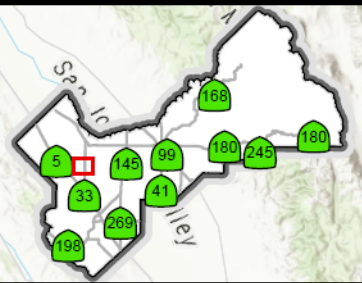
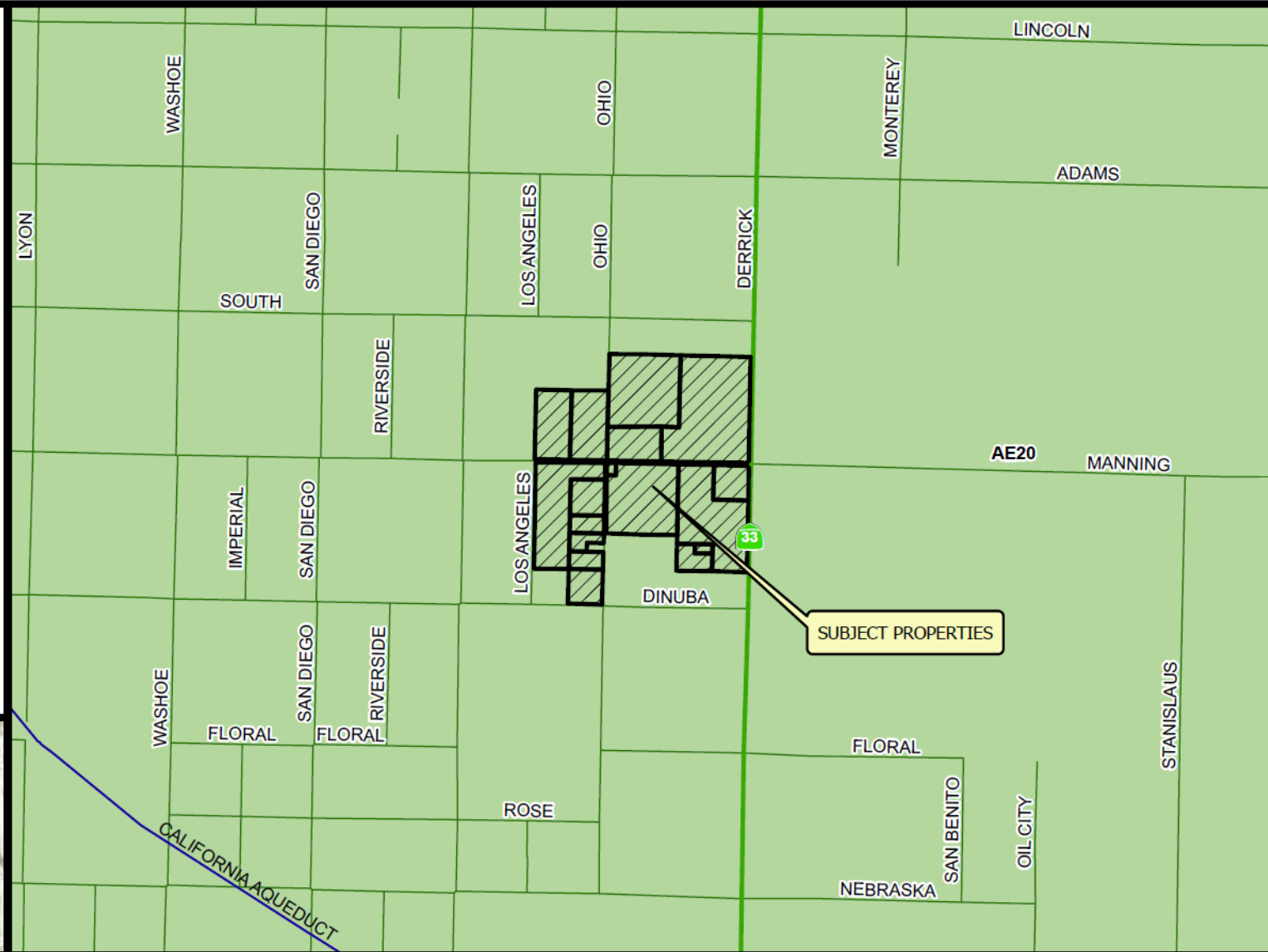

Existing Zoning Map

CUP 3786

STR 23, 24, 25, 26 - 15S / 14E

2024

Prepared by : County of Fresno, Department of Public Works and Planning, Development Services Division

Person Prepared by : chuang

On Date : 3/8/2024

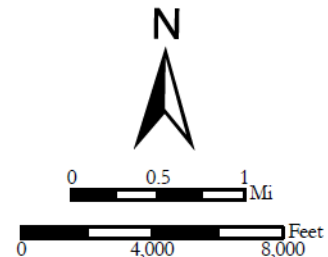

LEGEND:

 Subject Properties

 Ag Contract Land

LEGEND
DRY - DRY FARMING
FC - FIELD CROP
ORC - ORCHARD
PWR - POWER GENERATION SITE
SF# - SINGLE FAMILY RESIDENCE
V - VACANT

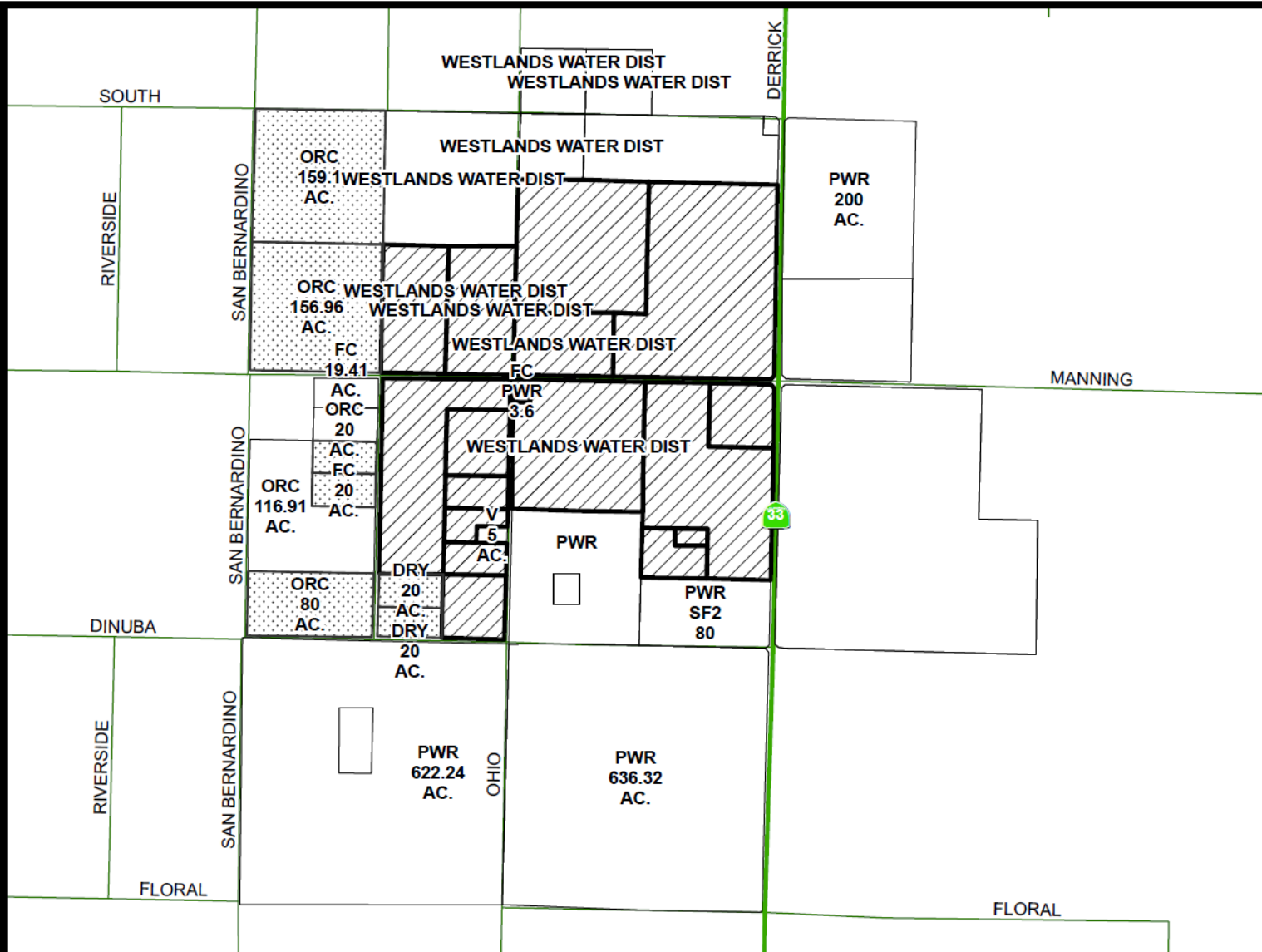
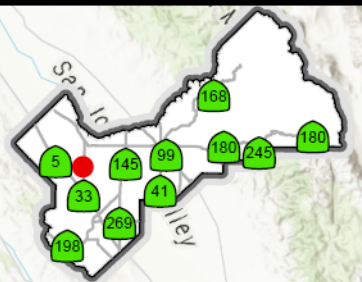

Existing Land Use Map

CUP 3786

2024

Prepared by : County of Fresno, Department of Public Works and Planning, Development Services Division
 Person Prepared by : chuang
 On Date : 3/7/2024

