



DEPARTMENT of PUBLIC WORKS and PLANNING
DEVELOPMENT SERVICES & CAPITAL PROJECTS DIVISION

VA 4187



Legend



Subject Property

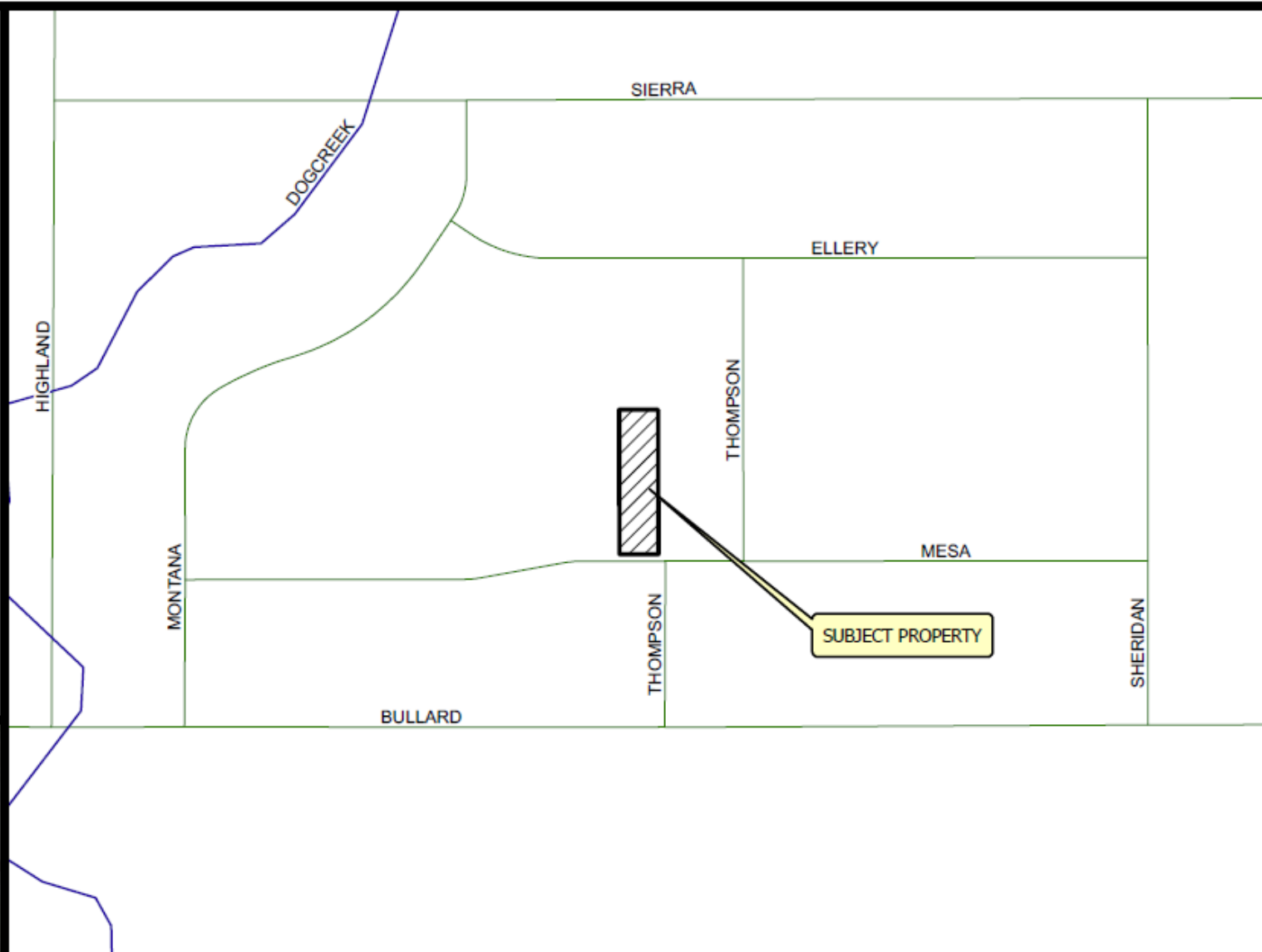

VICINITY MAP

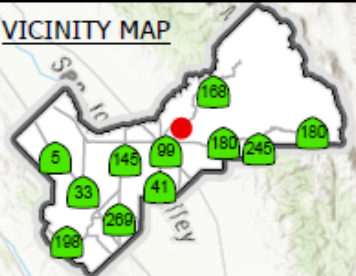

LOCATION MAP

VA 4187

2025

Prepared by : County of Fresno, Department of Public Works and Planning, Development Services Division
Person Prepared by : tsrisukwatana
On Date : 4/4/2025

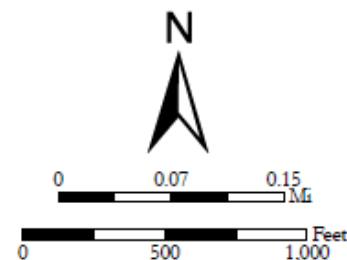

Legend

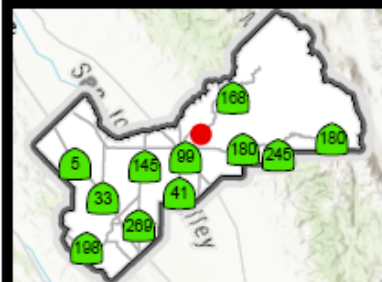
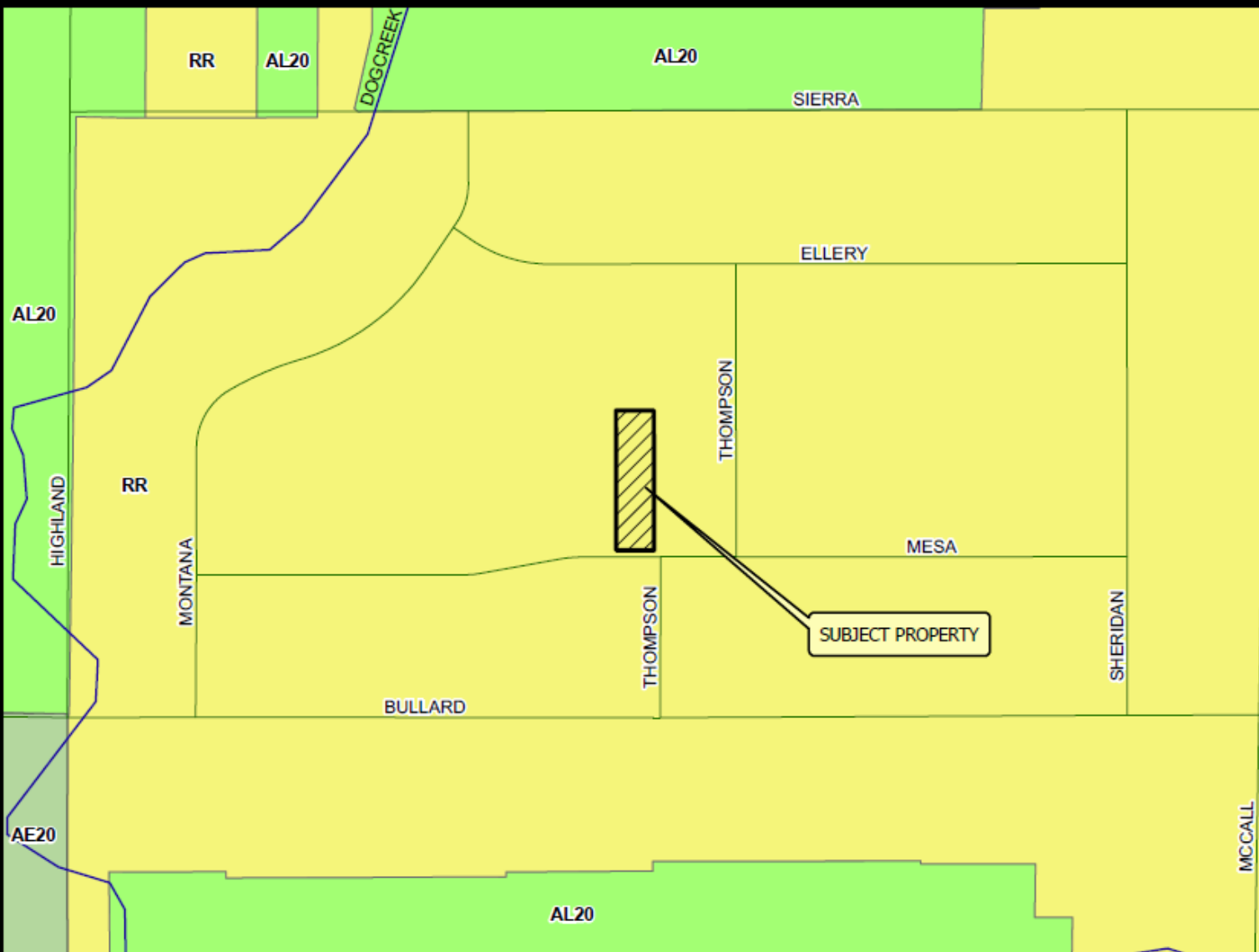
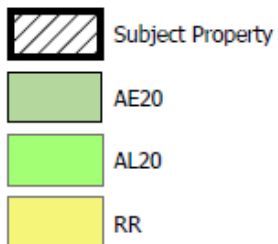

Existing Zoning Map

VA 4187

STR 6 - 13S / 22E

2025

Prepared by : County of Fresno, Department of Public Works and Planning, Development Services Division

Person Prepared by : tsrisukwatana

On Date : 4/4/2025

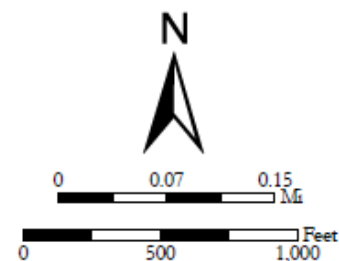

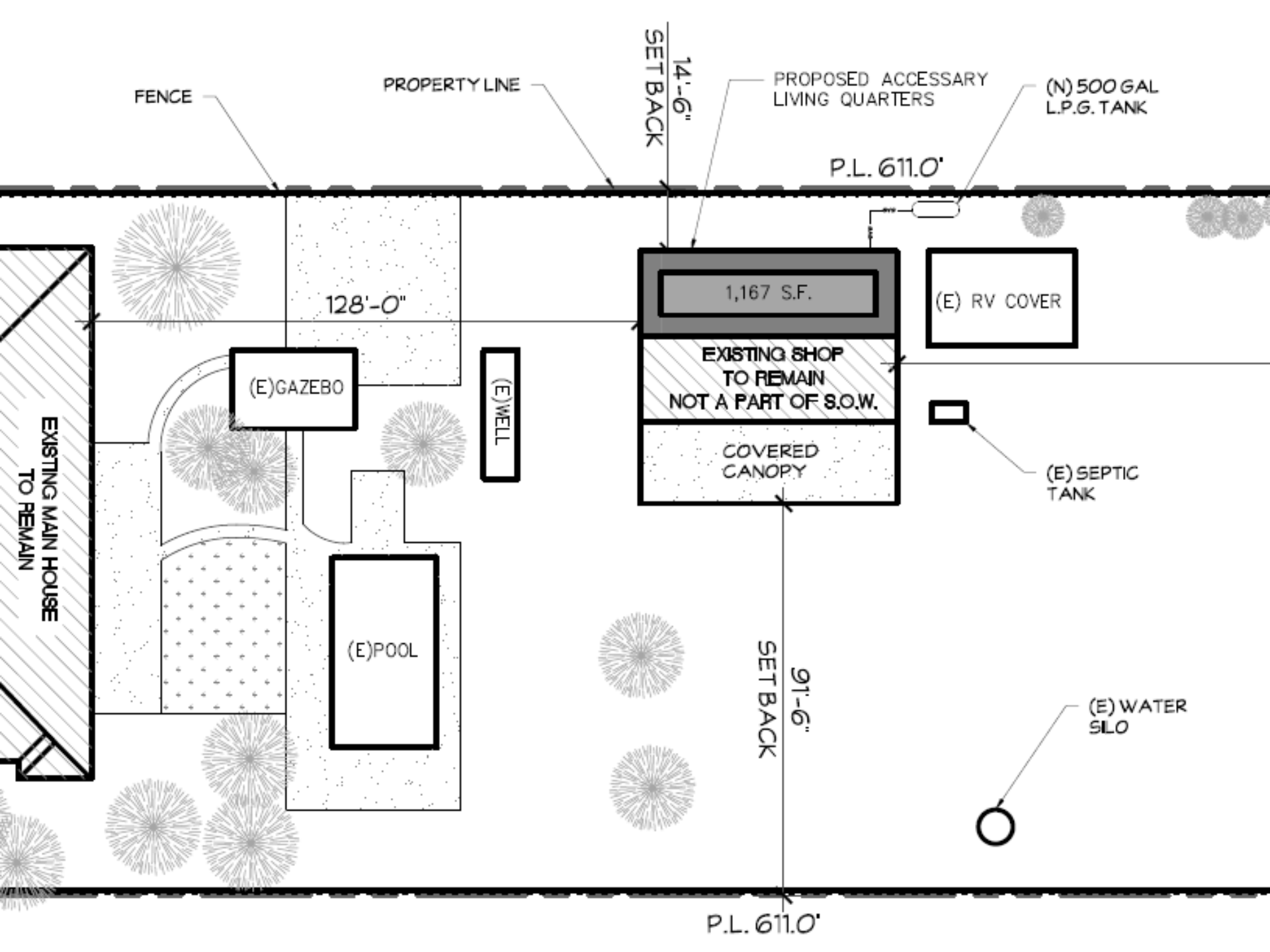



Findings	Description	Findings Met
1	Exceptional or extraordinary circumstances	NO
2	Preserves property right possessed by others	NO
3	No adverse effect on neighborhood	YES
4	General Plan consistency	YES



DEPARTMENT of PUBLIC WORKS and PLANNING
DEVELOPMENT SERVICES & CAPITAL PROJECTS DIVISION

VA 4187

