

CONSTRUCTION IN A FLOOD HAZARD AREA



Development NEAR a flood zone (within 200 feet)

- Provide a map of survey, stamped and signed by a Professional Land Surveyor.
Map must highlight:
 - o Property's information (address, APN, etc.).
 - o Flood area boundaries and flood area designation.
 - o Corresponding FIRM Panel Number.
 - o Proposed location of structure.
 - o Distance from structure to flood area boundaries.
 - o Professional Land Surveyor's stamp, signature, and contact information.
- A \$83.02 review fee will apply in addition to any grading permit fees.
- A Grading Permit is required.
- No permits will be issued until map is reviewed and accepted by the Grading Engineer.

Development WITHIN a flood zone

New construction

- Provide an Elevation Certificate based on construction drawings prepared by a certified professional.
- A \$83.02 review fee will apply per Elevation Certificate in addition to any grading permit fees.
- A Grading Permit is required.
- No permits will be issued until initial Elevation Certificate is reviewed and approved and all necessary fees are collected.
- Prior to occupancy, an Elevation Certificate based on final construction is required. Review fee applies:
 - o Final Elevation Certificate MUST demonstrate compliance to ordinance.
 - o No occupancy will be granted until final Elevation Certificate is approved and all necessary fees are collected.

Additions to existing structures

- Provide a current (6 months old or less) certified appraisal of the existing structure OR most recent tax assessment for the structure.
- Provide an itemized Construction Cost Estimate from a licensed contractor.
- If determination is made that the cost of construction of the proposed improvements is **less than 50%** of the value of the existing structure:
 - o Provide an Elevation Certificate based on construction drawings for the proposed work and prepared by a certified professional. Lowest floor elevation of proposed improvements may match elevations of existing structure.
 - o A \$83.02 review fee will apply per Elevation Certificate in addition to any grading permit fees.
 - o A Grading Permit is required.
 - o No permits will be issued until initial Elevation Certificate is reviewed and approved and all necessary fees are collected.
 - o Prior to occupancy, an Elevation Certificate based on final construction is required. Review fee applies.
 - o No occupancy will be granted until final Elevation Certificate is approved and all necessary fees are collected.
- If determination is made that the cost of construction of the proposed improvements is **more than 50%** of the value of the existing structure:
 - o The proposed improvements AND the existing structure MUST comply with the elevation requirements.
 - o Provide an Elevation Certificate based on construction drawings prepared by a certified professional.
 - o A \$83.02 review fee will apply per Elevation Certificate in addition to any grading permit fees.
 - o A Grading Permit is required.
 - o No permits will be issued until initial Elevation Certificate is reviewed and approved and all necessary fees are collected.
 - o Prior to occupancy, an Elevation Certificate based on final construction is required. Review fee applies.
 - o No occupancy will be granted until final Elevation Certificate is approved and all necessary fees are collected.

VICINITY MAP

NOT TO SCALE

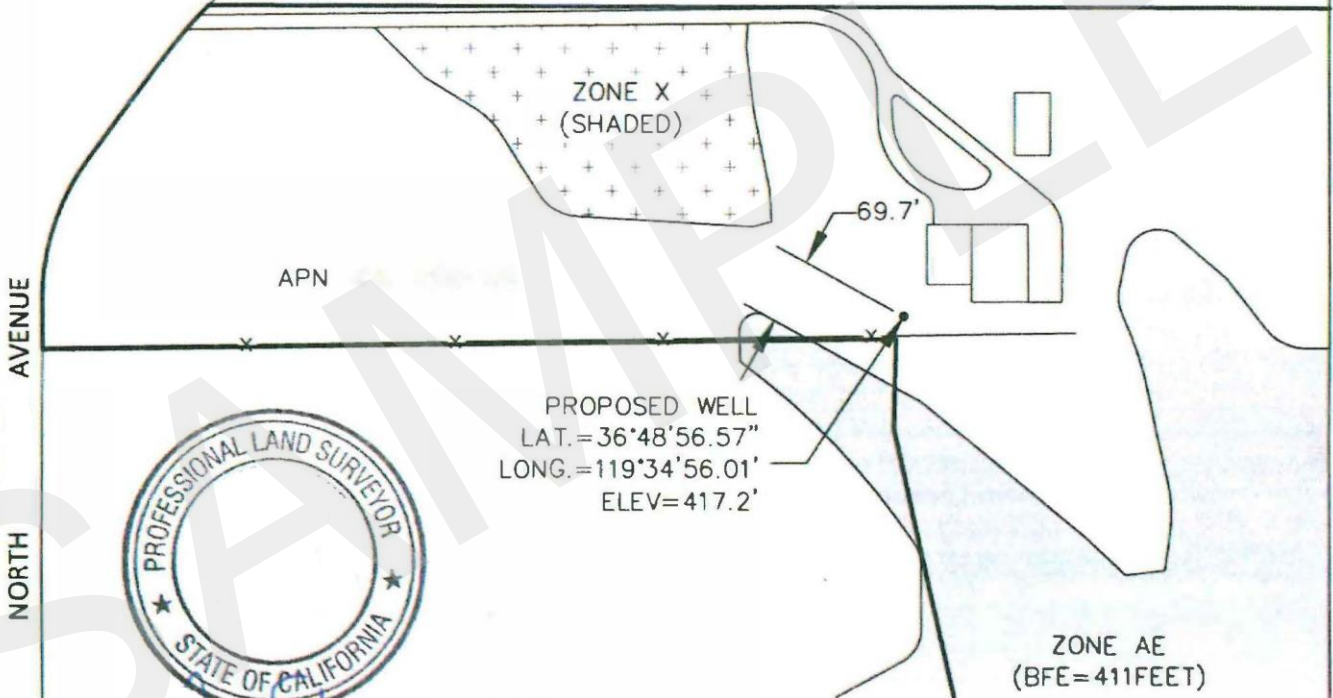
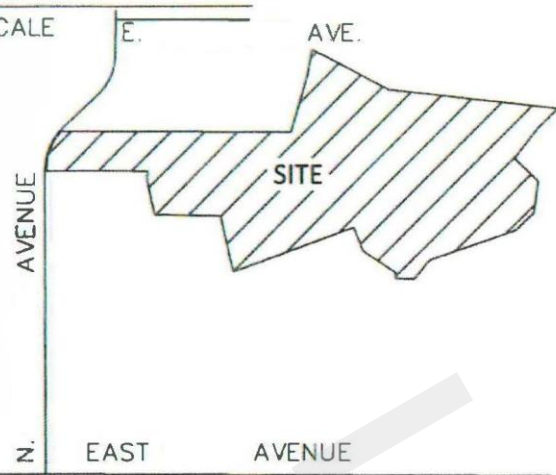

NOTES

1. FLOOD ZONE INFORMATION SHOWN HEREON IS BASED ON INFORMATION SHOWN ON THE FEMA FLOOD INSURANCE RATE MAP FOR COMMUNITY NO. 065029, PANEL NO. 1605, MAP NO. 06019C1605H, DATED FEBRUARY 18, 2009.
2. THE PROPOSED BUILDING LOCATION IS BASED ON FIELD MEASUREMENTS OF THE PROPOSED WELL SITE ON JANUARY 28, 2016.

LEGEND

□ AREA WITHIN FLOOD ZONE AE, BASE FLOOD ELEVATION = 411 FEET

GRAPHIC SCALE

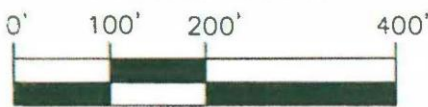

(IN FEET)
1 inch = 200 ft.

FLOOD ZONE EXHIBIT
PROPOSED WELL
AVENUE
CLOVIS, CA

DRAWN BY:

DATE:

CLOVIS, CA 93612
(559)